

LESS FRAME MORE VIEW

FINTECNIC
vedi la differenza

MORE
VIEW



LARGE-DIMENSIONED SLIDING DOOR WITHOUT VISIBLE ALUMINIUM PROFILES

MORE
VIEW



MORE
VIEW



MORE
VIEW



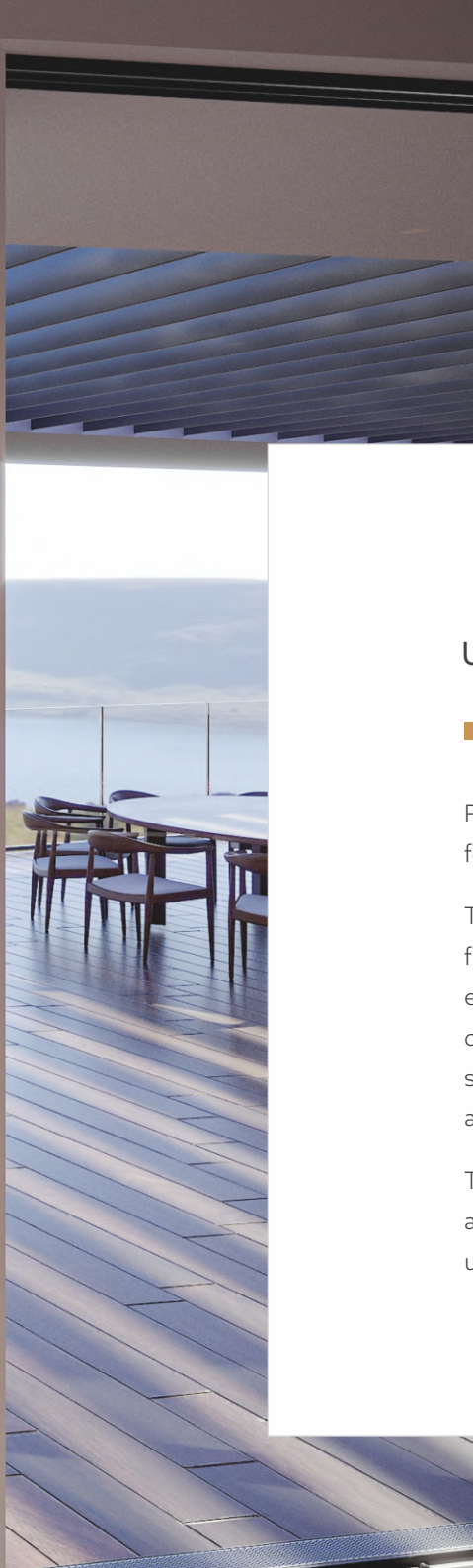

UNLIMITED POSSIBILITIES TO DESIGN THE SPACE

Panoramic view of the surrounding, optically enlarged living space and the feeling of connection with nature are just few of many advantages of sliding doors designed on the basis of the Moreview system.

The state-of-the-art, minimalist design of this solution allows for hiding the aluminium frame of the structure in the floor, walls and the ceiling, thus the boundary between the house interior and the outside surrounding is blurred. This effect is enhanced by the threshold-free construction which facilitates moving. The Moreview system allows for designing glazings without aluminium elements being visible from outside. Thus, the effect of almost uniform glass surface is achieved with discrete division lines. What is more, the glass corner allows for connecting glass sheets at any angle.

The feeling of unlimited space is ensured by slightly visible width of the door leaf connection, the smallest size of visible aluminium available at the market as far as movable mullion is concerned, as well as permitted height of the structure up to 4 m. Despite of large size of designed solutions, the entire structure is light and subtle.



COMFORT AND FUNCTIONALITY

- Unlimited access to sunlight - transparency up to 98%.
- Structures based on the Moreview system can have the height up to 4 m.
- The possibility of glazing with triple pane units up to 60 mm thick.
- Independent structures of the Moreview system can be connected at 90° angle.
- A static mullion allows for designing a row of fixed glazing which can be additionally connected at any angle thanks to using an all-glass corner.
- Manual or automatic control. The control mechanism is hidden or assembled at the outside of the construction.
- The possibility of glazing from the outside.
- Linear drainage integrated with the frame.
- The Moreview system allows for the replacement of worn guide rolls without the necessity to disassemble heavy door leaves.
- Patented solution of divided chicane profile ensuring easy assembly and the possibility of the fitting replacement without the necessity of the leaf disassembly.





MORE
VIEW



TECHNICAL PARAMETERS

Air permeability (acc. to PN EN 12207)	class 4
Water tightness (acc. to PN EN 12208)	class 9A
Wind load resistance (acc. to PN EN 12210)	C4
Thermal insulation	U from 0,7 W/m ² K
Anti-theft protection	class RC2
Acoustic insulation	Rw = 42dB
Impact resistance (acc. to PN EN 14019)	I5/E5

	manually operated sliding leaf	automatically operated sliding leaf	fixed leaf
Max. weight	400 kg	1200 kg	1000 kg
	leaf	double-rail frame	triple-rail frame
Profiles depth	72 mm	192 mm	294 mm

CONSTRUCTION POSSIBILITIES OF THE MOREVIEW SYSTEM IN A DOUBLE-RAIL VERSION

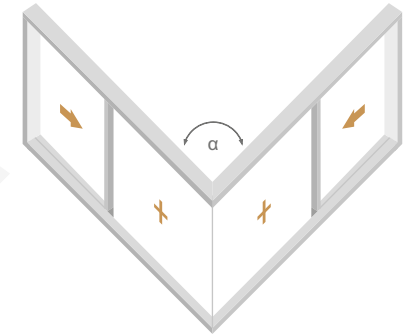
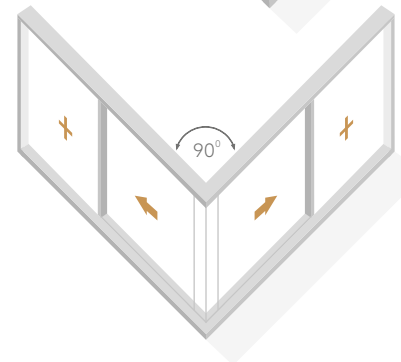
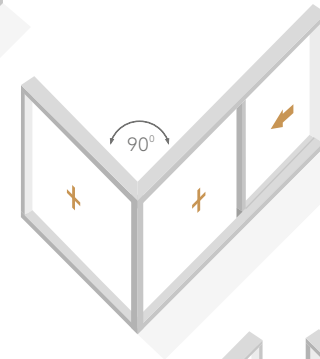
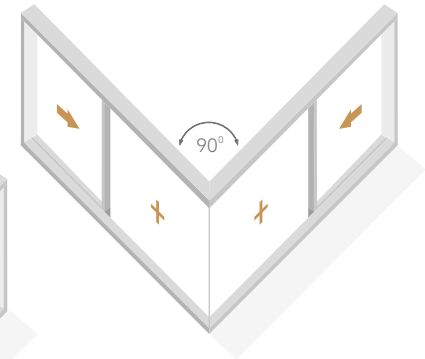
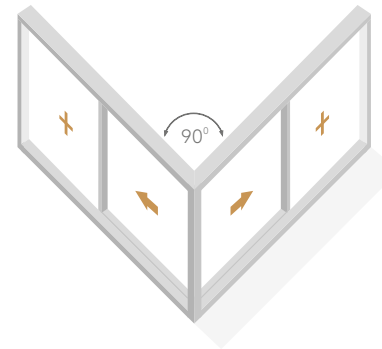
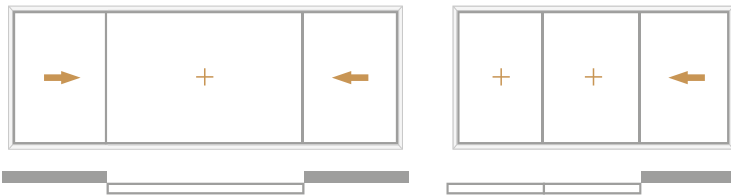
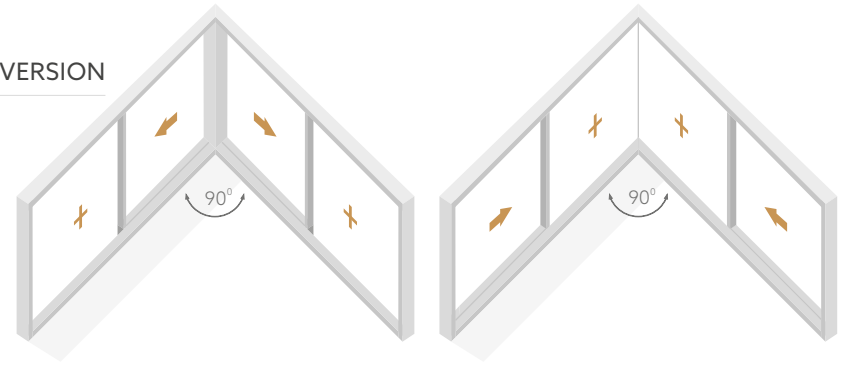
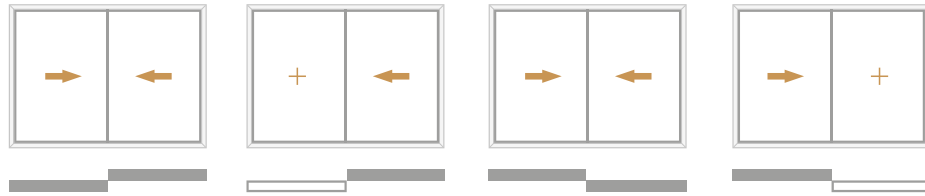



CONSTRUCTION POSSIBILITIES OF THE MOREVIEW SYSTEM IN A SINGLE-RAIL VERSION

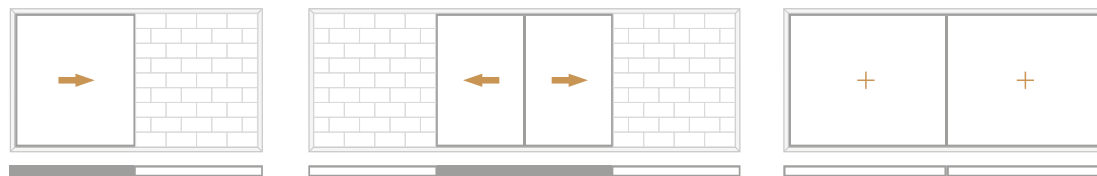

CONSTRUCTION POSSIBILITIES OF THE MOREVIEW SYSTEM IN A TRIPLE-RAIL VERSION

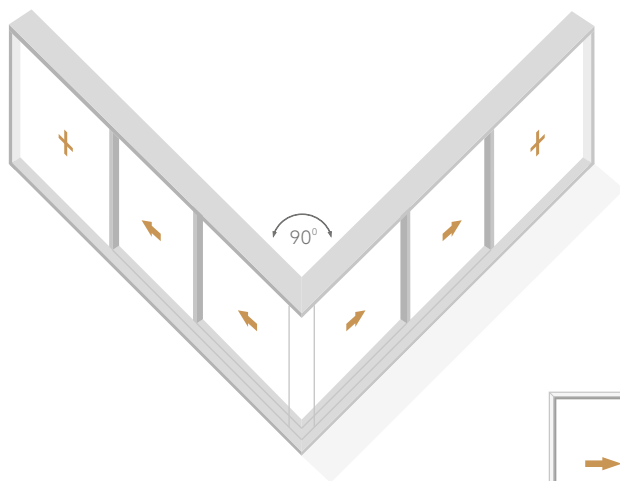



THE MOREVIEW SYSTEM CROSS-SECTIONS

The door cross-section at the floor level

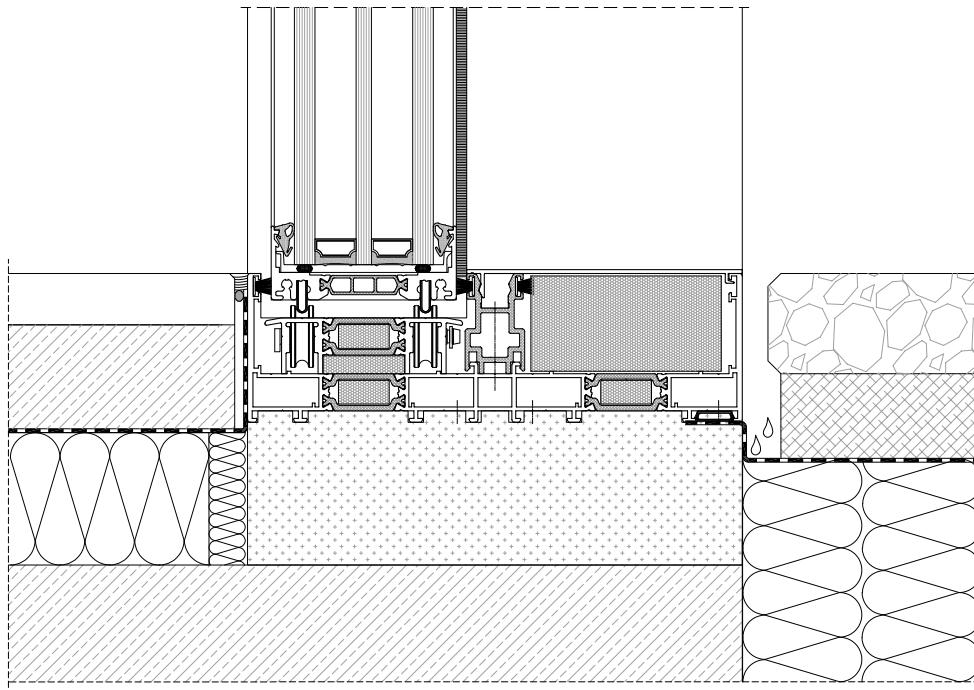

Cross-section through the leafs assembly

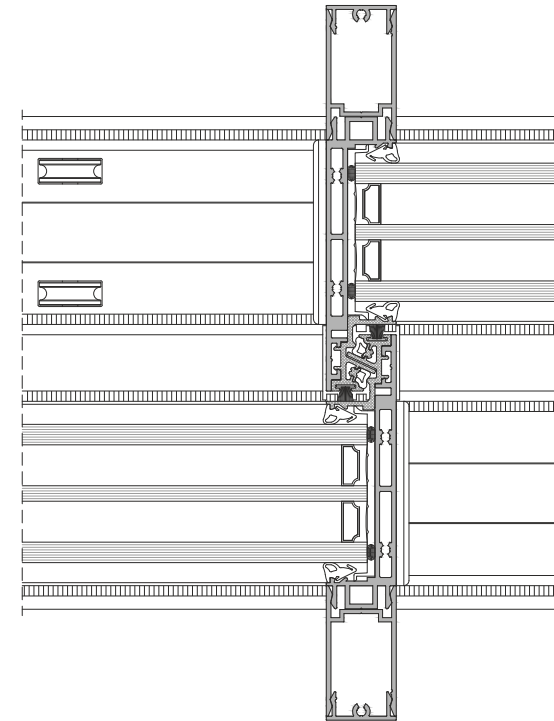



THE MOREVIEW SYSTEM CROSS-SECTIONS

Lateral cross-section

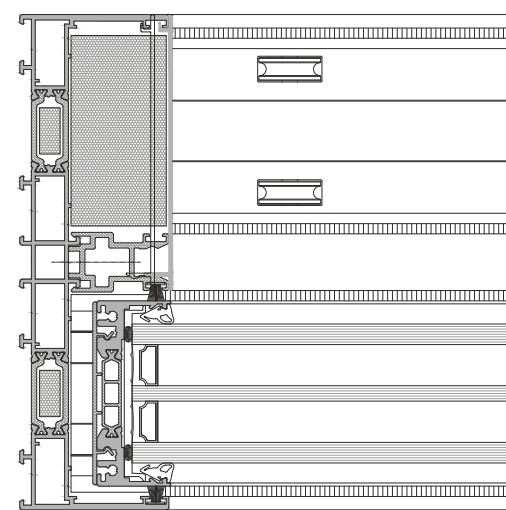

MORE
VIEW



MORE
VIEW





www.fintecnic.pl/en